



Brushing Technology

Flexible sanding tools





We would like to introduce you with our brushing system which is a quick, efficient and economic solution to sand solid wood, wooden-based materials and lacquer coatings.

Thanks to the optimized parameters of our abrasive brushes and careful selection of raw materials we are able to handle the most difficult and untypical challenges, while guaranteeing satisfaction and measurable benefits such as increase of efficiency, better quality of sanded work-pieces and very competitive prices. With many years of experience we can develop and provide any sanding tool.

Our steel and tynex heads are used in the increasingly popular wood treatment technology known as wood structuring.



FLEXIBLE SANDING TOOLS

Advantages of our technology:



We are a manufacturer with many years of experience who can offer brushes in two types of spline : plastic (for lighter sanding) and metal (for more aggressive sanding).

Our brushes construction guarantess durability due to the selection of best available on the market abrasive cloths and supporting filaments. We can offer a variety abrasive brushes with different types of grain and bristle support.



In our products we use bristles characterized by anti-static properties, which prevent electrostatic loads on the surface of sanded work-pieces. Additionally, our bristles have excellent sanding, polishing and cleaning properties including dust removal.



We can offer abrasive brushes with single or double filament support, with height from 20 mm to 110 mm. Abrasive cloth is available in few different widths of the cuts : 2, 4, 7, 20, 50, 100 mm or if needed without any cuts. Depending on our customers' needs the cuts on sanding material can be straight, rounded or diamond shaped.



Except for abrasive brushes production we also manufacture grooved heads for replaceable brushing system. Our heads come with different types of locking systems to ensure the easiest and fastest retooling process.



To meet our customers' expectations and requirements we can also produce unusual constructions of abrasive brushes and grooved heads.



SANDING HEADS

Our grooved heads guarantee long and trouble-free operation thanks to their appropriate design and precision of workmanship. We use stiff and deformation-resistant plastics as construction materials. This design allows to carry heavy loads during sanding process without compromising the durability of the head and the machine.

We can offer our heads with straight or spiral grooves, which, combined with the speed and the direction of head rotation, allows us to carefully and effectively sand both the surface and edges of the work-pieces. Depending on brushing machine's construction, we offer various locking systems, which makes abrasive brushes replacement simple and quick, without the need to dismantle the head from the machine.

TYPES OF SANDING HEADS

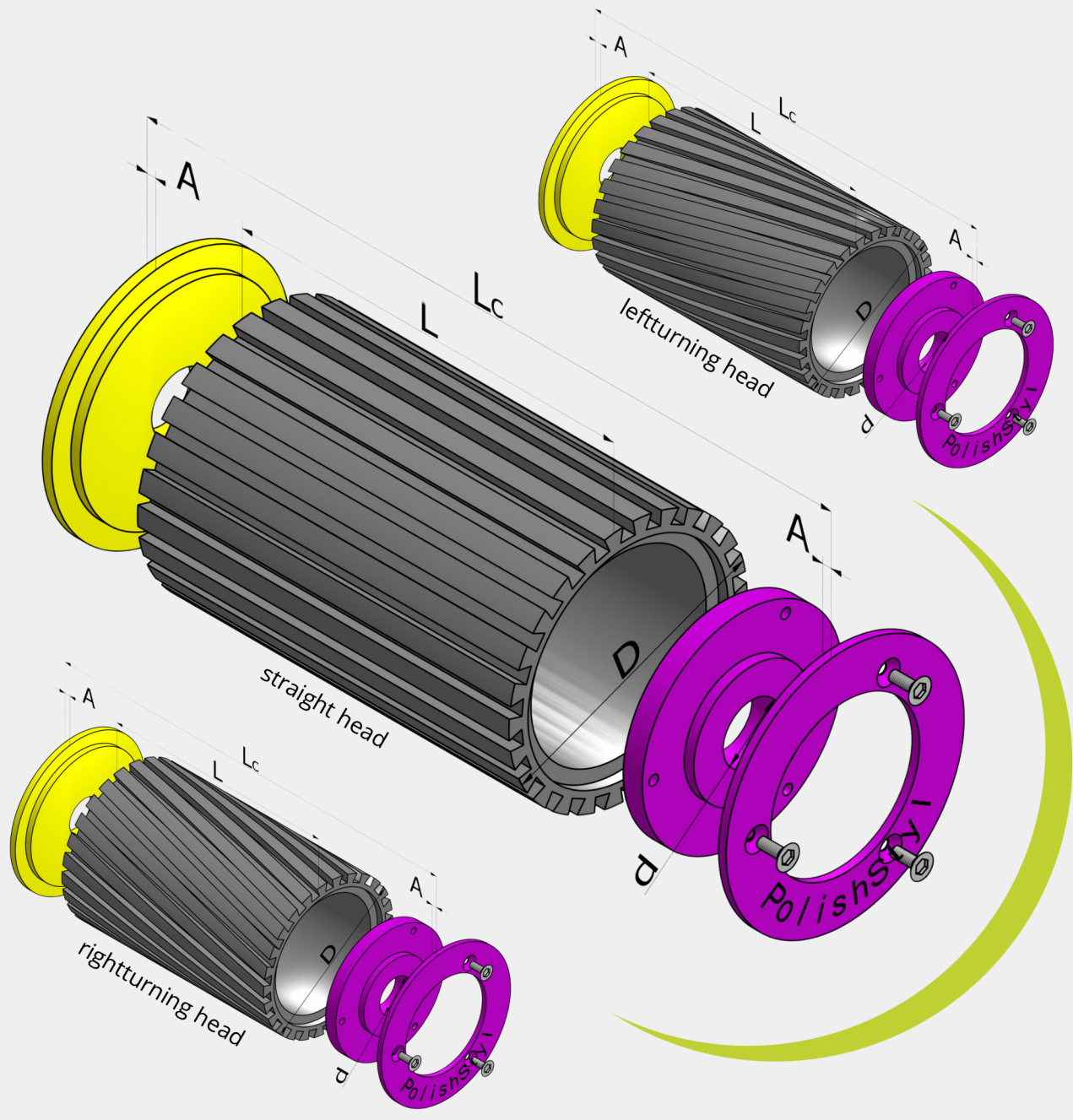

DIMENSIONS OF SANDING HEADS A ÷ H											
L	50 ÷ 2200 mm										
A	2 ÷ 5 mm										
B	15 ÷ 25 mm										
D	Ø 20 ÷ Ø 80 or other if needed										
d	Ø 56	Ø 60	Ø 80	Ø 100	Ø 110	Ø 115	Ø 125	Ø 150	Ø 180	Ø 280	Ø 310
QUANTITY OF BRUSHES	12	14	18	20	22	24	26	32	36	54	60
Non standard diameters - production leadtime 4 weeks											
Standard diameters - production leadtime 2 weeks											

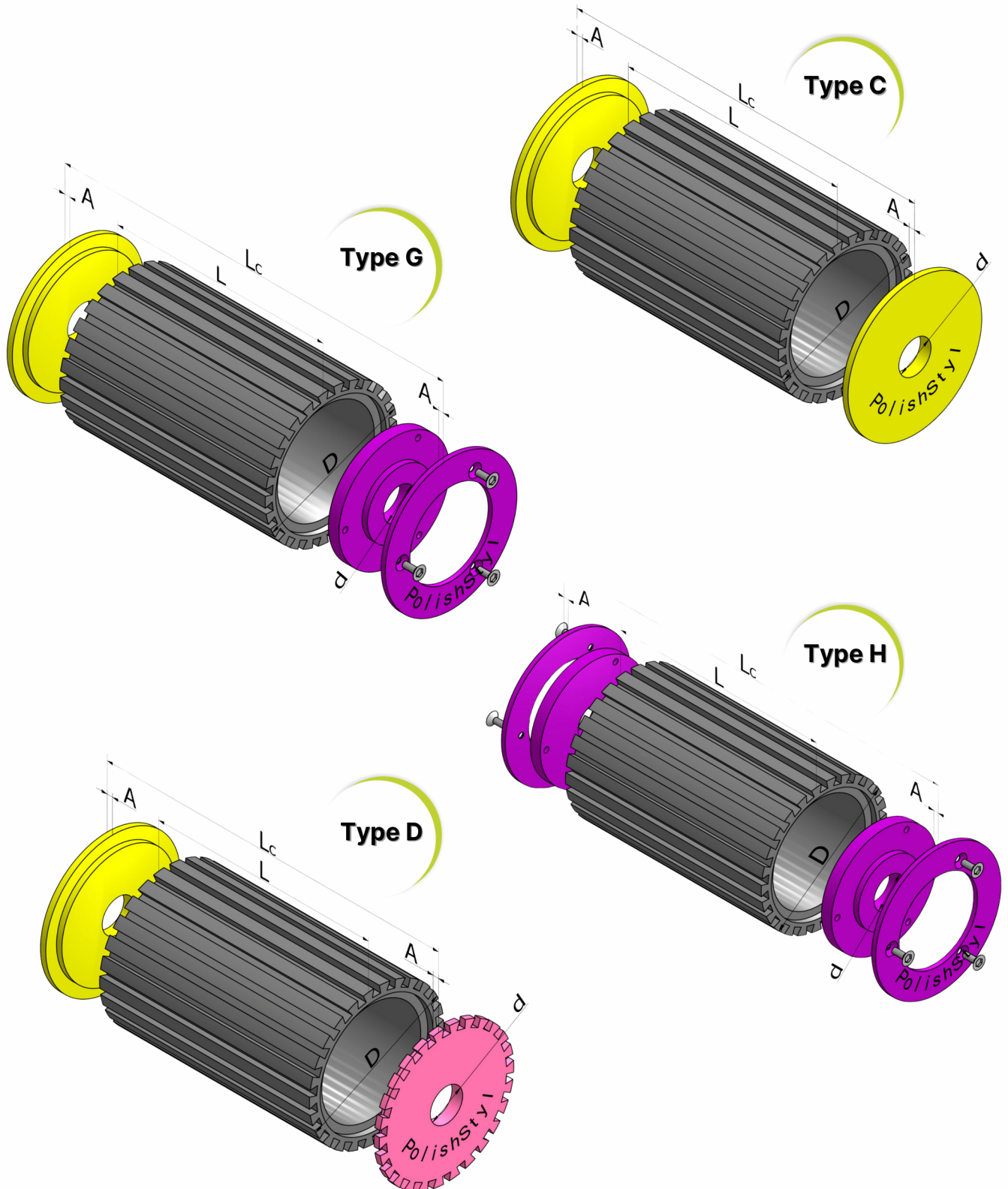

Types of sanding heads

All types of roller heads (A-H) can be produced with left-turning, right-turning or straight grooves.

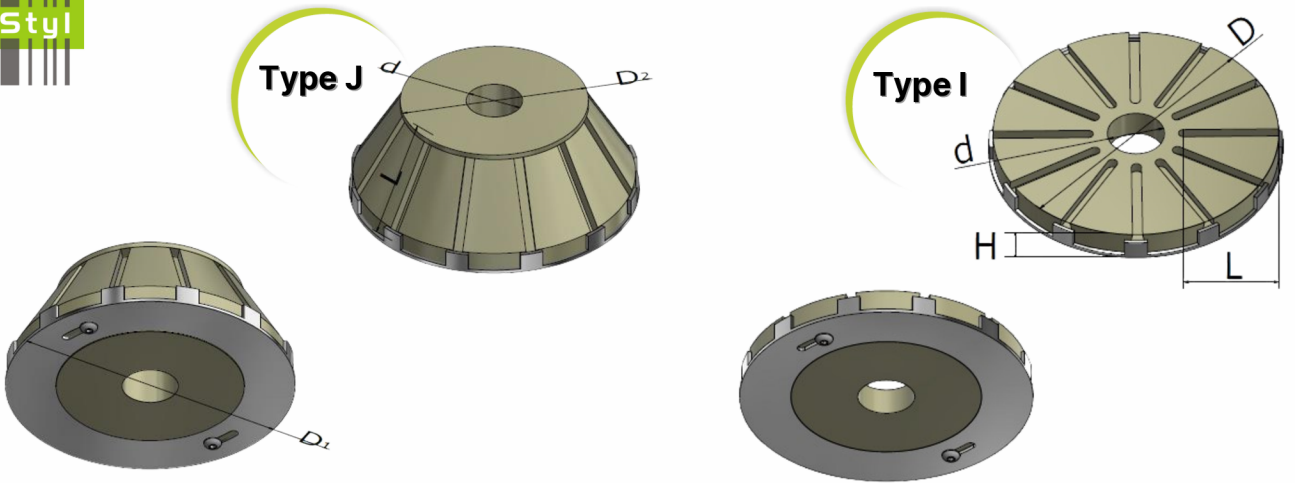

DIMENSIONS OF SANDING HEADS TYPES I & J	
H	15 ÷ 25 mm
d	Ø 20 ÷ Ø 50 or other if needed
D	Ø 130 ÷ Ø 300

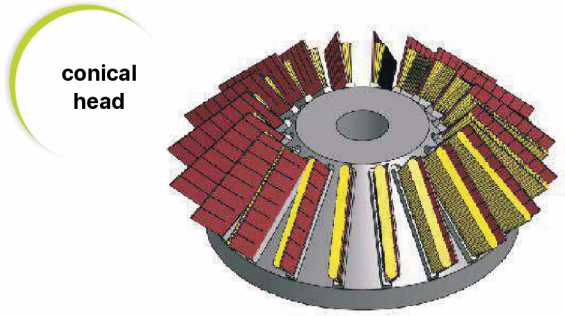
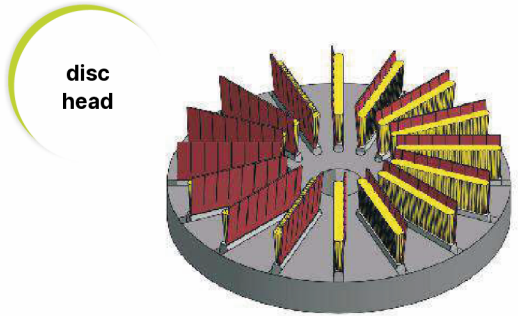
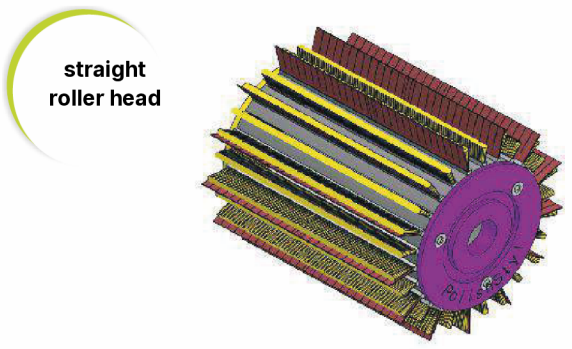
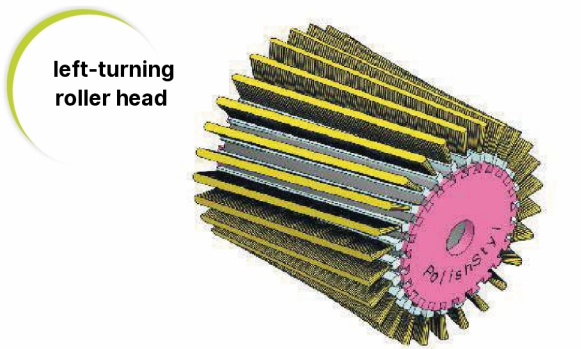



BRUSHES DIMENSIONS				
	Index	Cut shape	Description	Width of cuts
	I		Straight cut	2; 4; 7; 20; 50; 100; without cuts
	I		Rounded cut	
	I		Diamond cut	
H	Fiber height (mm)			20 ÷ 110
L	Length of sanding brush (mm)			35 ÷ 2500

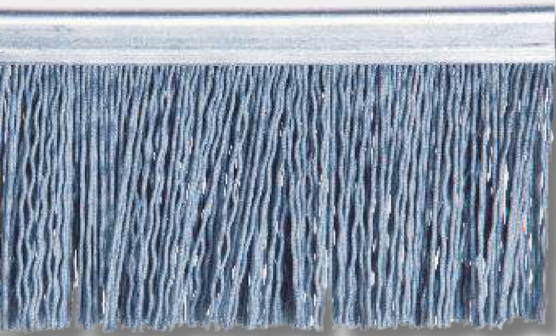

SANDING BRUSHES

Our exchangeable sanding brushes system which is used in all type of production lines. Our customers are big industrial factories, medium-sized factories as well as small carpentry shops. Depending on the technology of surface finishing we can offer brushes with sanding cloth, nonwoven, abralon, natural or PP fibers and horse hair, Proper selection of sanding cloth, grain, type of cuts and support system can guarantee optimalization of sanding processes.

TYPES OF SANDING BRUSHES



DERTamp

metal spline

Sanding brush with abrasive cloth

Possible grain types:

AlO - Aluminum Oxide

SiC - Silicon Carbide

CER - Ceramic

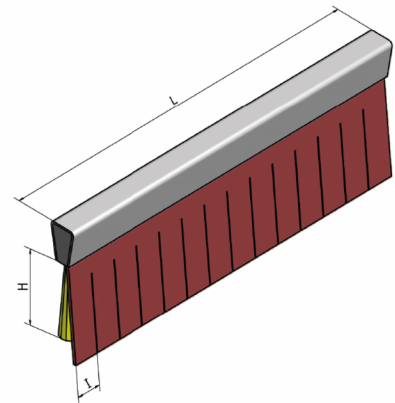
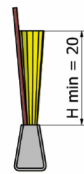
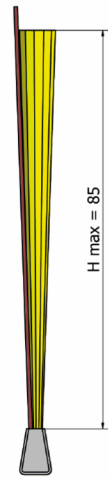

Tamp

metal spline

Supporting brush with

Tampico fiber

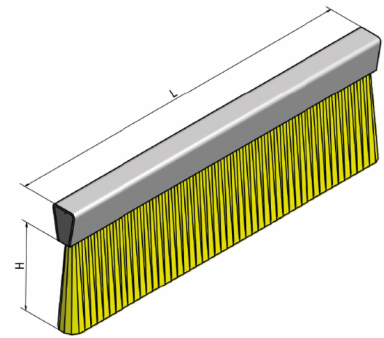
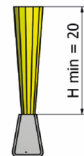
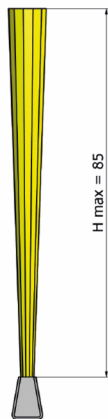

HORSET

metal spline

Cleaning and dedusting brush
with horse hair

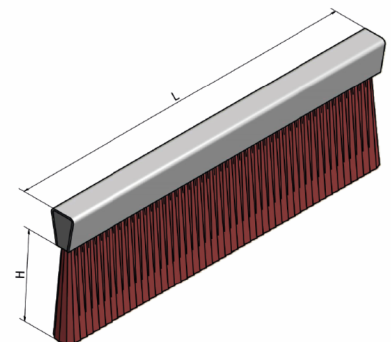
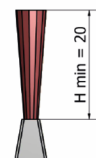
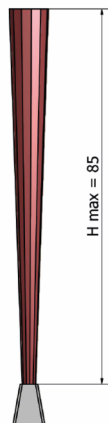

TYPES OF SANDING BRUSHES



W/Tamp

metal spline

Sanding brush with non woven abrasive

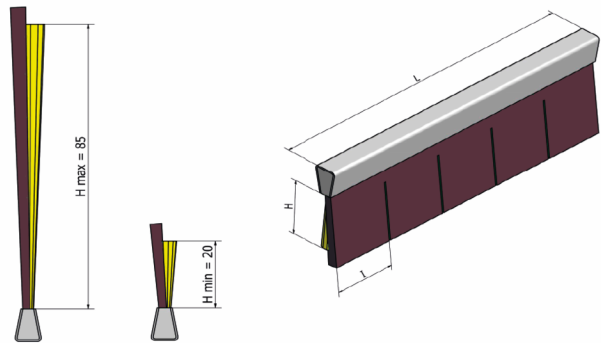

ABRAT

metal spline

Light Structuring brush with Abralon (Tynex) fiber

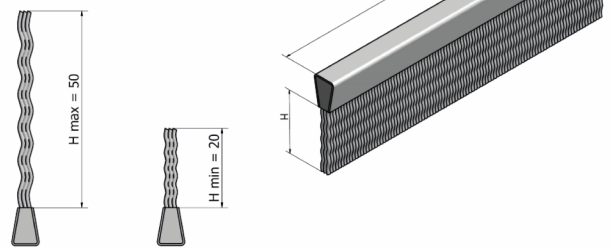

DERTamp/F

plastic spline

Sanding brush with abrasive cloth

Possible grain types:

AlO - Aluminium Oxide

SiC - Silicon Carbide

CER - Ceramic

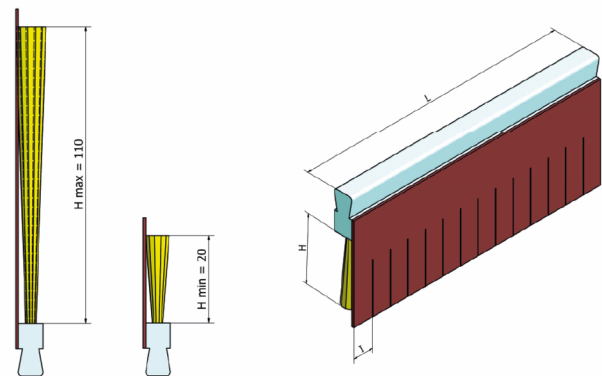

10



Tamp/F

plastic spline

Supporting brush with Tampico fiber

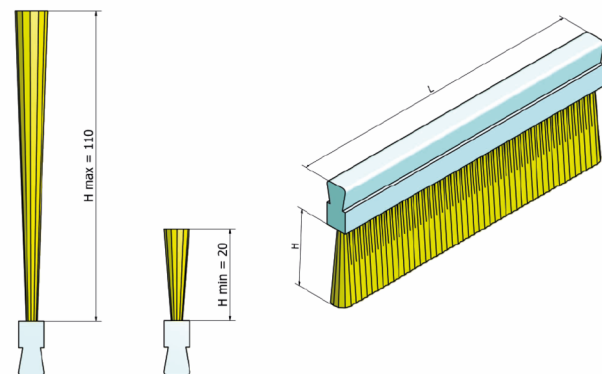

DERTamp2/F

plastic spline

Sanding brush with abarasive cloth and two lines of Tampico fiber

Possible grain types:

AlO - Aluminum Oxide

SiC - Silicon Carbide

CER - Ceramic

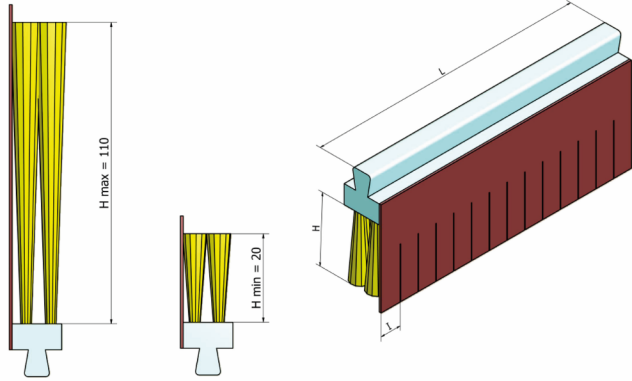

Tamp2/F

plastic spline

Supporting brush with two lines of Tampico fiber

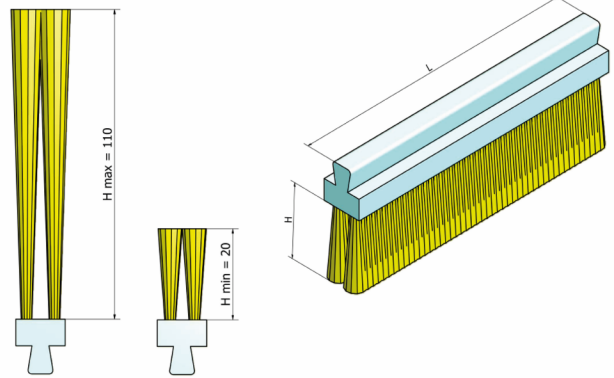

2DERTamp/F

plastic spline

Sanding brush with abrasive cloth from both sides

Possible grain types:

AlO - Aluminium Oxide

SiC - Silicon Carbide

CER - Ceramic

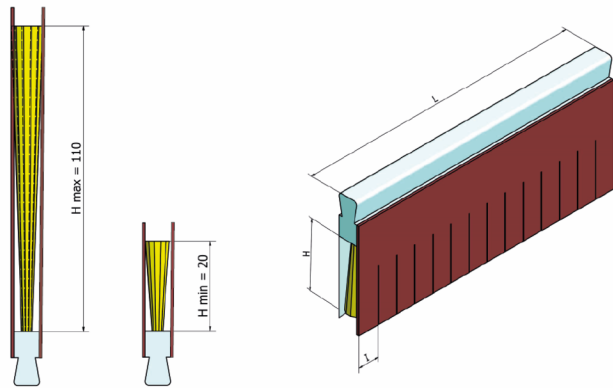
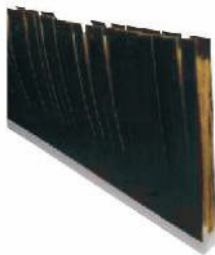

2DERTamp2/F

plastic spline

Sanding brush with abrasive cloth from both sides and two lines of Tampico fiber

Possible grain types:

AlO - Aluminium Oxide

SiC - Silicon Carbide

CER - Ceramic

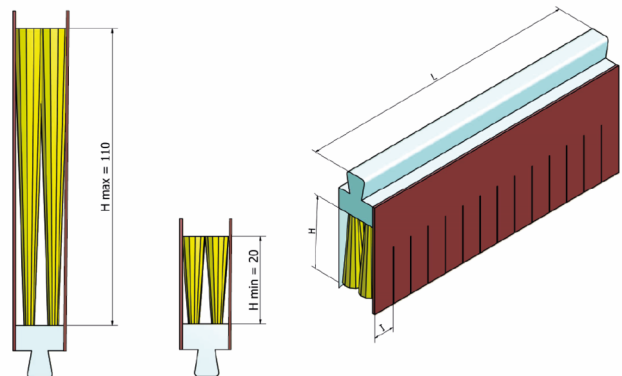



Sanding
challenging
elements
has never
been easier!



The technology of replaceable abrasive brushes by PolishStyl is a flexible system that the user can adapt to his own needs.

It guarantees simple, effective and economic sanding of elements that are generally considered difficult, such as grooved, milled or profiled fronts!



1

DISC HEAD

For sanding surfaces and elements with irregular shapes, such as milled furniture fronts, PolishStyl recommends the use of disc heads.

The head is offered with a set of brushes (10 pcs.).

It is designed to be installed on power tools with an M14 thread.



Watch video



2

BIG ROLLER HEAD

In case of deeper profiles and directional grooves, PolishStyl recommends using a big roller head with dimensions: D=80 mm (3,15 inch) & L=75 mm (2,953 inch). It is offered with a set of brushes (18 pcs.). Height of the brush, type of grain and grit is selected accordingly to customers' production process and requirements.

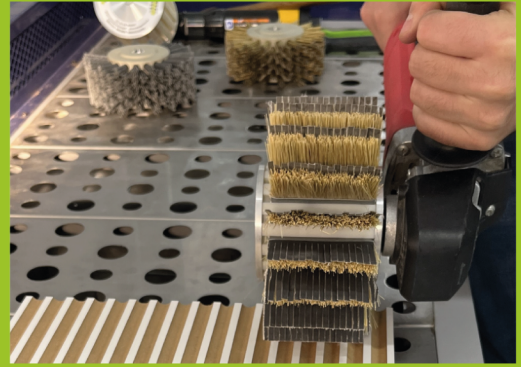

The roller head is available with two mounting systems:

Watch video



1. With a standard M14 thread for mounting on power tools.

Watch video



2. With a shaft for mounting on a drill.



3

SMALL ROLLER HEAD

For sanding of straight surfaces and profiles, PolishStyl recommends using a small roller head with dimensions: D=60 mm (2,36 inch) & L=60 mm (2,36 inch).

It is offered with a set of brushes (14 pcs.). Height of brush, type of grain and grit is selected accordingly to customers' production process and requirements.

Designed for installation on power tools with a drill chuck.

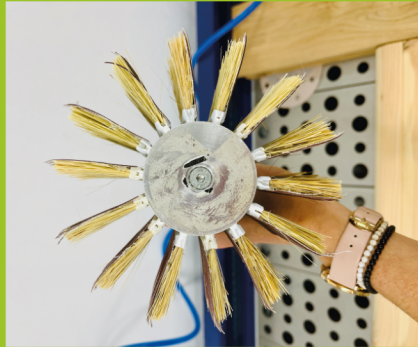

Watch video



4

PNEUMATIC SANDER

We can also offer a pneumatic tool for a quick and effective sanding of wood and wooden-based materials. Perfect for work where mobility and high efficiency is needed. Works great on both raw materials and during intermediate sanding.

It has easy speed regulation (with possibility of right-left rotation) in the range of 100-1600 rpm (3 gears).

The weight of the tool with head and brushes is only 1,2 kg (2 lb). It is offered with a set of 14 brushes. The recommended supply pressure is 6,3 bar.

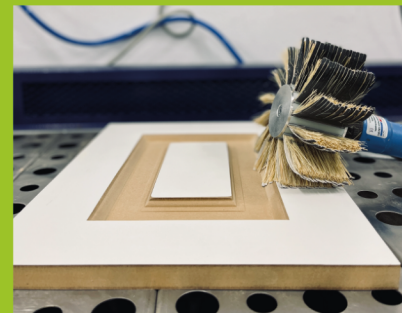

CONTACT



Address

Siedleckiego 9
39-460 Nowa Dęba
Poland

Phone

Infoline | +48 15 687 50 21
Artur Zalewski | +48 501 378 703

Web & Mail

Email: polishstyl@polishstyl.com.pl
Email: artur.zalewski@polishstyl.com.pl
Web: www.polishstyl.com.pl

